

## Rotary Switches

### CK 10xx

- Standard-One-Level rotary switch with maximum 12 operating positions
- The number of switching positions is from 2 to 12, adjustable and limited due to a stopwasher
- Solder pin terminals (PC-contact)
- 5A/300V,

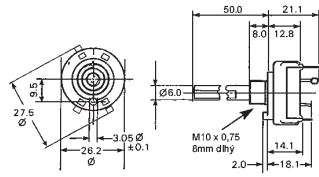

CK 1029

CK 1030

CK 1031

CK 1032

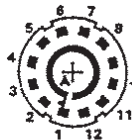

1-pólový,  
12 polóh



2-pólový,  
6 polóh



3-pólový,  
4 polohy



4-pólový,  
3 polohy

Part No.	Ord. No.	Description
S CK-1029	35505	1x12positions
S CK-1030	35506	2x6 positions
S CK-1031	35507	3x4 positions
S CK-1032	35508	4x3 positions

## Slide Switches

### SRS 3 P

1-pole, 0,5A/125V, soldering eyelets mounting holes 15,5mm, slide size 6mm, toggle: WxHxD = 3x4x3mm body depth L=5mm

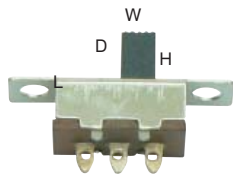

Part No.	Ord. No.
S SRS 3 P	16256
S SRS22F	63346

### SRS22F

2-poles, 0,5A/50V, soldering eyelets mounting holes 19mm slide size 8,9mm toggle: WxHxD=5,5x9,2x3,8mm body depth L=7mm



### SRR 6 P

2-poles, 0,3A/125V, soldering eyelets mounting holes 28mm slide size 12,2mm toggle: WxHxD=6,6x9x5,6mm body depth L=6,6mm

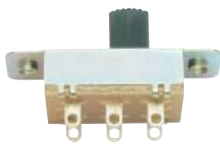

Part No.	Ord. No.
S SRR 6 P	16254

### S 6 P

2-poles, 0,3A/125V, soldering eyelets mounting holes 19mm slide size 8,9mm toggle WxHxD=5x8,3x3mm body depth L=7mm



Part No.	Ord. No.
S S 6 P	16255
S GS 373	16257

### GS 373

2-poles, 3 positions PCB mounting, distance mounting holes 19mm, slide size 8,9mm, toggle dimensions WxHxD=6x8x4mm, body depth L= 12mm.

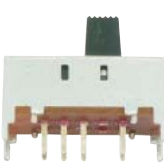

### ESP 101

Sub-Slide Switch SPDT PC vertical 1-pole, 0,5A, 12Vdc/1mA

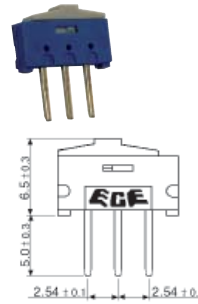

### ESP 201

Sub-Slide Switch SPDT PC horizontal 1-pole, 0,5A, 12Vdc/1mA

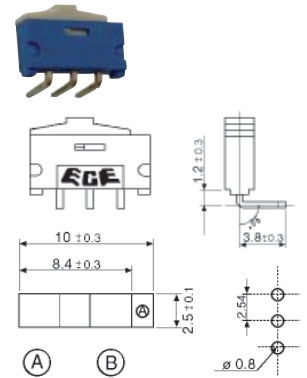

Part No.	Ord. No.
S ESP 101	4111
S ESP 201	4186

### 9078.0101

Slide switch 1-pole, PCB 30V/100-mA.

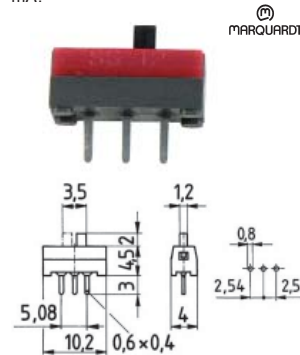

### 9078.0201

Slide switch 2-poles, PCB 30V/100-mA.

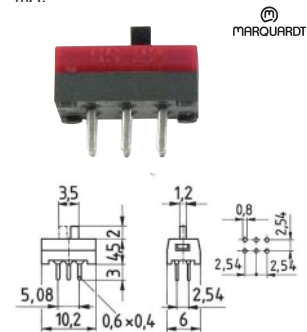

Part No.	Ord. No.
S 9078.0101	60839
S 9078.0201	52183

## DIP Switches

### ESD

SMD DIP switches, RM=2,54mm, 25mA/24Vdc.

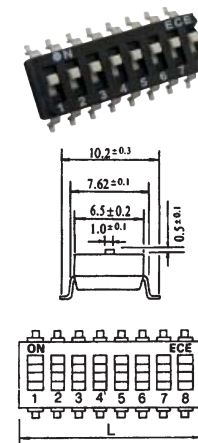

### DS

Mini DIP switches, RM=2,54mm, 50mA/24Vdc.

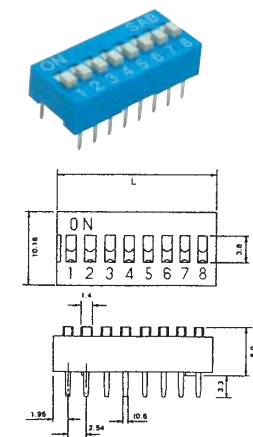

Part No.	Ord. No.
S ESD102EZ SMD	9264
S ESD104EZ SMD	28308
S ESD108EZ SMD	28309
S DS 02	18932
S DS 03	18926
S DS 04	16258
S DS 06	16259
S DS 08	16260
S DS 10	16261