

DA
Mini DIP switches, vertical,
RM=2,54mm, 50mA/24Vdc.

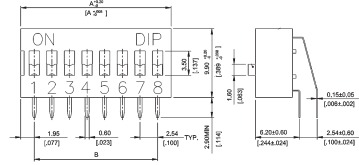

DP
Piano DIP switches, RM=2,54mm,
50mA/24Vdc.

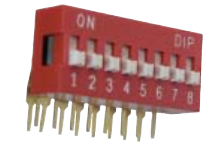
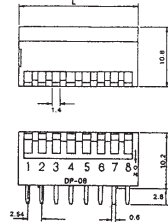
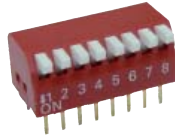

Part No.	Ord. No.
S DA 02	28332
S DA 04	28334
S DA 08	28338
S DP 02	28329
S DP 04	22644
S DP 08	22646
S DP 10	22647

Rotary DIL Switches

KDR 10-DEC/BCD
10x10mm, PCB mounting.

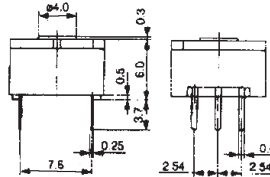

Part No.	Ord. No.
S KDR 10-DEC/BCD	20407

KDR 16
10x10mm, PCB mounting.

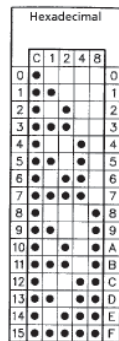
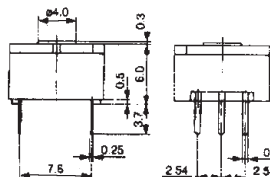

Part No.	Ord. No.
S KDR 16	20408

PCB Mount Pushbuttons

DS 660 SS
1A/125V, RM=5mm, modular.

MIYAMA

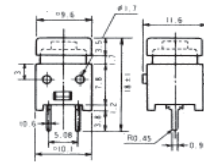

Part No.	Ord. No.	Description
S DS 660 SS RD	28301	red
S DS 660 SS BL	28302	black

DT 6
Round 9mm PCB mount, 0,1A/100V,
outside diameter \varnothing 12mm.

DTE 6
Square 7,7mm x 7,7mm PCB mount
0,1A/100V, outside diameter \varnothing 12mm

ECONOMIC

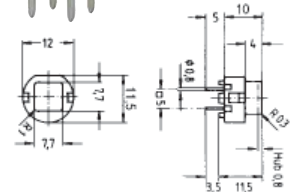
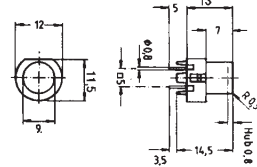

Part No.	Ord. No.	Colour
S DT 6 BL	4677	blue
S DT 6 RT	2983	red
S DT 6 SW	2453	black
S DT 6 WS	3316	white
S DTE 6 SW	8563	black

SDT 21 LP
1A/120V, PCB 90, silver-plated contacts

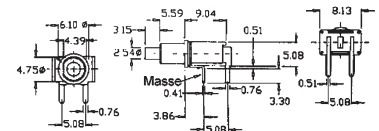

Part No.	Ord. No.
S SDT 21 LP	6078